

Stock Molds for 150 Extruder

MOLD NUMBER

15-D-7-L

ESTIMATED YIELD
90 ft/yd
36 m/m³

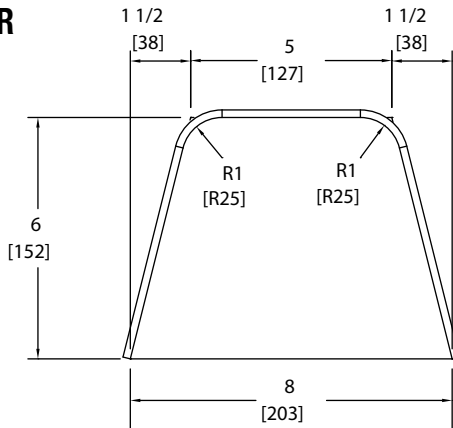

MOLD NUMBER

15-C-L

ESTIMATED YIELD
97 ft/yd
39 m/m³

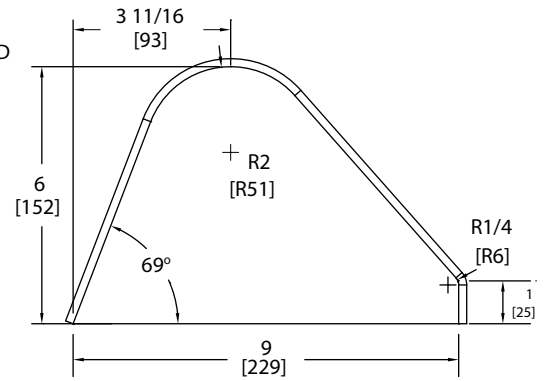

MOLD NUMBER

15-381-L

ESTIMATED YIELD
84.5 ft/yd
33 m/m³

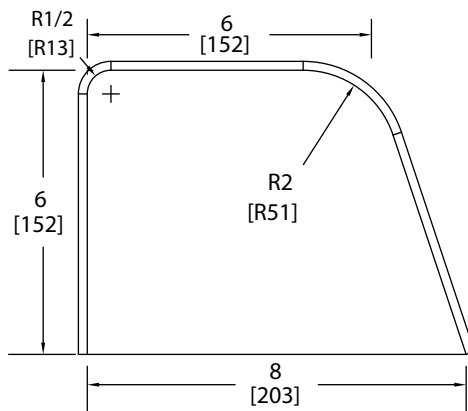

MOLD NUMBER

15-070-L

ESTIMATED YIELD
103 ft/yd
41.5 m/m³

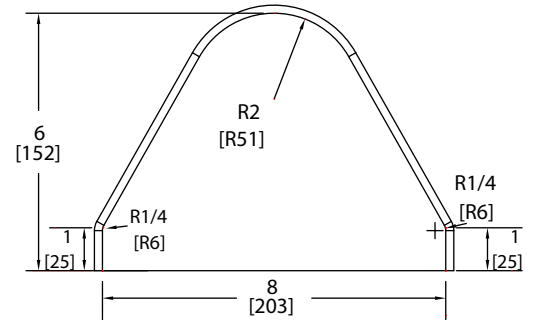

MOLD NUMBER

15-019-L

ESTIMATED YIELD
97 ft/yd
39 m/m³

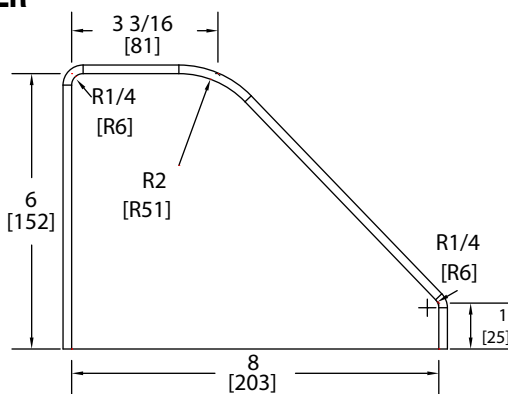

MOLD NUMBER

15-K-L

ESTIMATED YIELD
96 ft/yd
38.4 m/m³

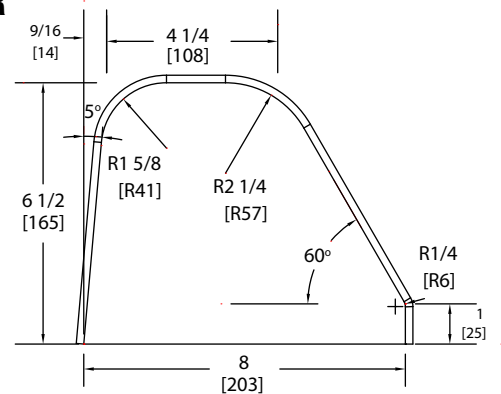

MOLD NUMBER

15-011-L

ESTIMATED YIELD
107.5 ft/yd
42.8 m/m³

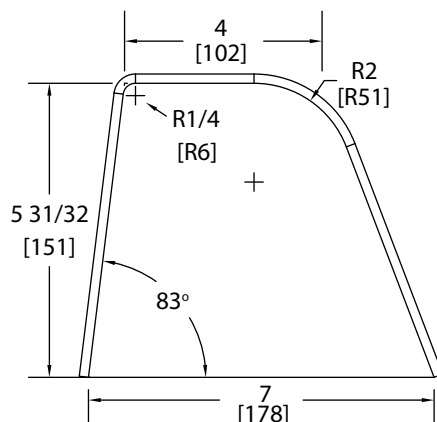

Power Curbers & **Power Pavers** INC.

Stock extruder molds can be ordered directly through the Power Curbers Parts Department:

Power Curbers, Inc.
727 Bendix Drive
Salisbury, NC 28146

parts@powercurbers.com
Phone: 704.647.6195
Fax: 704.603.1995

For more information about molds, visit www.powercurbers.com/molds